

TANK MOUNTED STRAINER – TMH

FLUDEN

- TANK MOUNTED REUSABLE STRAINER
- SIDE WALL OR TANK TOP MOUNTING
- FLOWS TO 40 GPM (160 LPM)
- STAINLESS STEEL PLEATED MEDIA
- 100 MESH (149 MICRON) STANDARD
- STEEL HOSE BARB FITTING

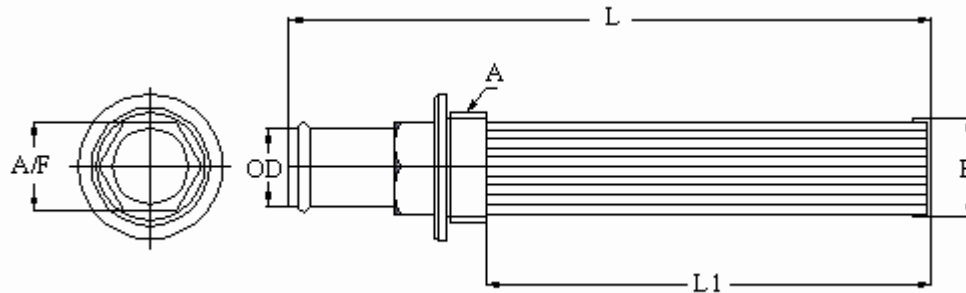
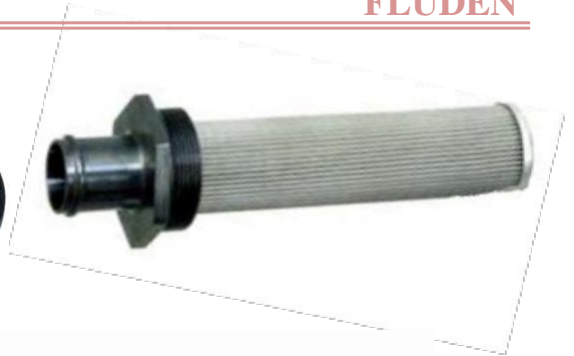

| Series | Bushing Size | | LPM / GPM Rating | Screen Area SQ. IN. | Dimensions | | | | WT. KGS |
|----------|--------------|-------|------------------|---------------------|------------|-----|------|-------|---------|
| | THD. A | O.D. | | | L | L1 | E | A / F | |
| TMH - 04 | 1-5/16" | 25.40 | 016 / 4 | 42 | 140 | 80 | 28.0 | 38.00 | 0.25 |
| TMH - 10 | 1-7/8" | 25.40 | 040 / 10 | 100 | 236 | 170 | 45.0 | 31.75 | 0.40 |
| TMH - 20 | 2-1/2" | 31.75 | 080 / 20 | 160 | 254 | 188 | 51.0 | 38.10 | 0.60 |
| TMH - 25 | 3-3/8" | 31.75 | 100 / 25 | 230 | 262 | 183 | 81.0 | 50.80 | 1.10 |
| TMH - 30 | 3-3/8" | 38.10 | 120 / 30 | 230 | 262 | 183 | 81.0 | 50.80 | 1.10 |
| TMH - 40 | 3-3/8" | 50.80 | 160 / 40 | 230 | 275 | 183 | 81.0 | 63.50 | 1.20 |

TOLARNCE = ± 1 MM

MODEL CODE : ASSEMBLY

| TMH | 2 0 | | -149 | RB3 | Recommended |
|--------|------|-------------------|---------------------------------------|---------------------------|---------------|
| SERIES | SIZE | THREAD / HOSE DIA | MICRONS | | Weld Flange |
| | | STD | | OPTIONAL | To Be Ordered |
| | 4 | 16S / 1" Dia | 149 - SS 100 MESH STD | | Separately |
| | 10 | 24S / 1" Dia | 125 - SS 120 MESH | | TWF - 1 6 N |
| TMH | 20 | 32S / 1-1/4" Dia | 100 - SS 150 MESH | RB 3 3 P.S.I BYPASS VALVE | TWF - 2 4 N |
| | 25 | 48S / 1-1/4" Dia | 074 - SS 200 MESH | (OMIT IF NOT REQD.) | TWF - 3 2 N |
| | 30 | 48S / 1-1/2" Dia | 063 - SS 250 MESH | | TWF - 4 8 N |
| | 30 | 48S / 2" Dia | Also - 30 / 60 MESH (OMIT IF STD). | | TWF - 4 8 N |

CONTACT FACTORY FOR OPTIONAL FEATURE

DIMENSIONS IN MM FOR REFERENCE ONLY

PRODUCT UNDER DEVELOPMENT

APPLICATION OF THE TANK MOUNTED STRAINER

