

## TANK MOUNTED STRAINER – TMH

FLUDEN

- TANK MOUNTED REUSABLE STRAINER
- SIDE WALL OR TANK TOP MOUNTING
- FLOWS TO 40 GPM (160 LPM)
- STAINLESS STEEL PLEATED MEDIA
- 100 MESH ( 149 MICRON ) STANDARD
- STEEL HOSE BARB FITTING

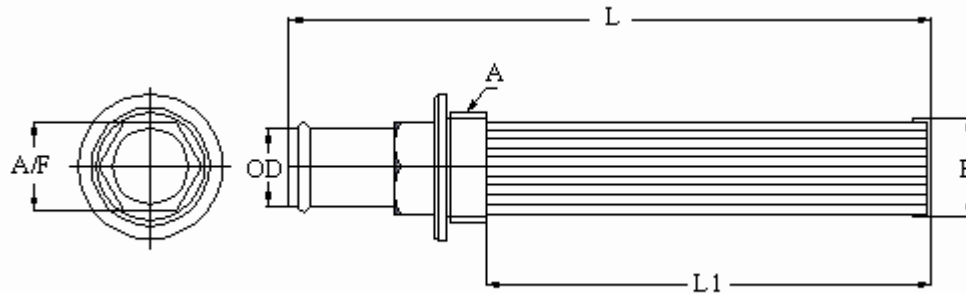
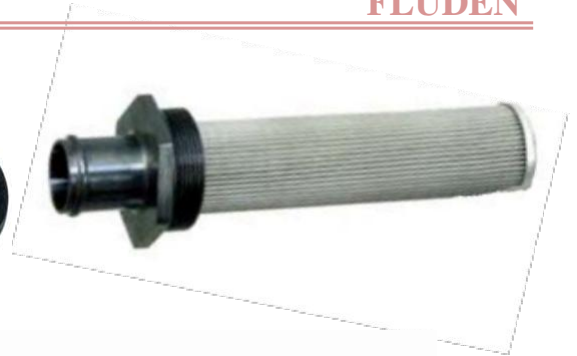

Series	Bushing Size		LPM / GPM Rating	Screen Area SQ. IN.	Dimensions				WT. KGS
	THD. A	O.D.			L	L1	E	A / F	
TMH - 04	1-5/16"	25.40	016 / 4	42	140	80	28.0	38.00	0.25
TMH - 10	1-7/8"	25.40	040 / 10	100	236	170	45.0	31.75	0.40
TMH - 20	2-1/2"	31.75	080 / 20	160	254	188	51.0	38.10	0.60
TMH - 25	3-3/8"	31.75	100 / 25	230	262	183	81.0	50.80	1.10
TMH - 30	3-3/8"	38.10	120 / 30	230	262	183	81.0	50.80	1.10
TMH - 40	3-3/8"	50.80	160 / 40	230	275	183	81.0	63.50	1.20

TOLARNCE = ± 1 MM

**MODEL CODE** : ASSEMBLY

TMH	20		-149	RB3	Recommended Weld Flange To Be Ordered Separately
SERIES	SIZE	THREAD / HOSE DIA STD	MICRONS	OPTIONAL	
TMH	4	16S / 1" Dia	149 - SS 100 MESH STD		TWF - 1 6 N
	10	24S / 1" Dia	125 - SS 120 MESH		TWF - 2 4 N
	20	32S / 1-1/4" Dia	100 - SS 150 MESH	RB 3 3 P.S.I BYPASS VALVE (OMIT IF NOT REQD.)	TWF - 3 2 N
	25	48S / 1-1/4" Dia	074 - SS 200 MESH		TWF - 4 8 N
	30	48S / 1-1/2" Dia	063 - SS 250 MESH		TWF - 4 8 N
	30	48S / 2" Dia	Also - 30 / 60 MESH (OMIT IF STD).		TWF - 4 8 N

CONTACT FACTORY FOR OPTIONAL FEATURE

DIMENSIONS IN MM FOR REFERENCE ONLY

**PRODUCT UNDER DEVELOPMENT**

**APPLICATION OF THE TANK MOUNTED STRAINER**

