

- REUSABLE SS 100 MESH / 149 MICRON STD
- STURDY ALL METAL STEEL CONSTRUCTION
- CONTINUOUS BONDING
- MAX. WORKING TEMP. 80 ° C.
- SUITABLE FOR HYDRAULIC / MINERAL OIL

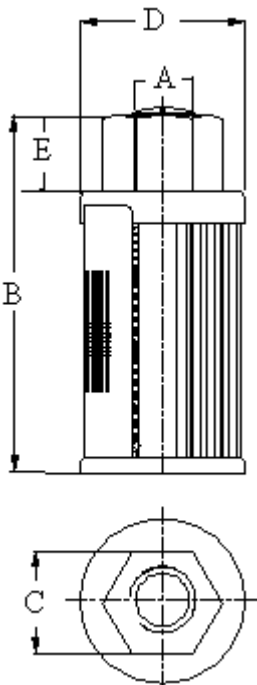
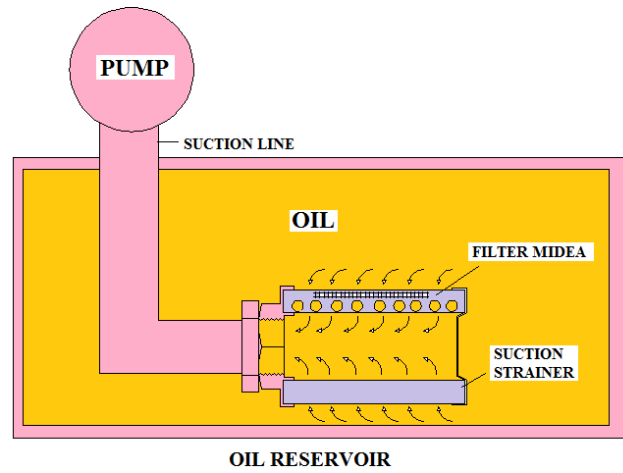

MODEL NO	FLOW	THREAD	OVERALL	NUT	CAP	NUT	SCREEN	WT.
	LPM	SIZE	LENGTH	A/F	DIA	LENGTH	AREA (SQ. IN)	
		A	B	C	D	E		KGS.
SC2-001	4	1/4"	64	22	35	12	19	0.06
SC2-003	12	1/4"	65	22	57	12	55	0.12
SC2-003	12	3/8"	65	25	57	12	55	0.13
SC2-005	20	1/2"	70	32	65	14	60	0.19
SC2-005	20	3/4"	70	36	65	14	60	0.2
SC2-007	28	1/2"	93	32	65	15	90	0.22
SC2-007	28	3/4"	93	36	65	15	90	0.24
SC2-010	40	1"	120	41	65	15	124	0.24
SC2-015	60	1 - 1/4"	144	50	85	15	170	0.36
SC2-020	80	1 - 1/2"	170	55	85	15	209	0.37
SC2-030	120	1 - 1/2"	195	55	85	15	245	0.49
SC2-040	160	2"	220	70	97	15	311	0.58
SC2-050	200	2"	247	70	97	15	350	0.64
SC2-075	300	2 - 1/2"	255	90	147	15	400	0.95
SC2-100	400	3"	300	100	147	15	500	1.15
SC2-150	600	3"	340	100	147	15	721	1.60

Note :-

*Suction strainer flow handling capacity is recommended 3 to 4 times greater than pump flow handling capacity.

* Tolerance: ± 1 MM

MODEL CODE: ASSEMBLY

S C 2	10	PORT		-149
SERIES	SIZE	THDS.	PORT THDS.	MICRONS
		SIZE	CONNECTION	OPTIONAL #
SC2			B - BSP - STD	149 - SS 100 MESH STD 125 - SS 120 MESH 100 - SS 150 MESH
			N-NPT OPTIONAL	074 - SS 200 MESH 063 - SS 250 MESH Also - 30 / 60 MESH

OMIT IF STANDARAD

CONSULT FACTORY FOR OPTIONAL / SPECIAL FEATURE

DIMENSIONS IN MM FOR REFERENCE ONLY